

# BALI 4.3

Patrizia (2020)



Conviva Maris D.O.O. • Paraćeva 8 • 21000 Split • Croatia

Phone: +385 91 300 2377

E-mail: [info@croatia-holidays-charter.com](mailto:info@croatia-holidays-charter.com)

Web: [www.croatia-holidays-charter.com](http://www.croatia-holidays-charter.com)

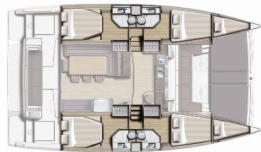

|                        |                              |
|------------------------|------------------------------|
| <b>Yacht Base</b>      | Capo D'orlando Marina, Italy |
| <b>Yacht ID</b>        | 7763                         |
| <b>Yacht Brands</b>    | Catana                       |
| <b>Yacht Name</b>      | Patrizia                     |
| <b>Production Year</b> | 2020                         |
| <b>Length</b>          | 13.20 M                      |
| <b>Cabins</b>          | 4 + 2                        |
| <b>Berths</b>          | 8 + 2                        |
| <b>WC</b>              | 4                            |

**COMFORT:** Cockpit cushions

**DECK:** Bilge pump – Mechanic, Bimini top, Boat hook, Bosun's chair (Safe seat) (boatswain's chair), Cockpit table, Cockpit/stern, outside shower, Diesel filter, Dinghy, Electric anchor windlass, Fenders, Flybridge, Gangway, Impeller, Main Deck Compass, Oil filter, Spare anchor (Reserve, Auxiliary anchor), Sun awning (forward cockpit), Swimming ladder

**ENTERTAINMENT:** Diving mask, Fins, Outdoor speakers, Radio mp3 player

**GALLEY:** Freezer, Gas cookers, Hot water, Ice box, Kitchen utensils (Galley equipment, cutlery), Microwave, Oven, Refrigerator, Salt water in kitchen

**INTERIOR:** Barometer, Bilge pump handle, Clock, Electric fans in cabins, Electric toilet

**NAVIGATION:** Autopilot, Binoculars, GPS chart plotter, Hand bearing compass, Log, Navigation/position Lights, Pilot book, Radar reflector, Tridata, Wind instrument/Anemometer

**SAFETY:** Automatic Inflatable Life Jacket, Black Water Tank, Distress flare box, Emergency tiller, Fire blanket, Fire extinguisher, First aid kit, Fog horn, Horseshoe lifebuoy, Life belts (Safety harness), Life buoy + Flashing light, Life jacket (children), Lifelines, Lifteraft, Set of tools, Torch, VHF radio

**SAILS:** Electric winch

**YACHT ELECTRICS:** 12V Socket, 220V socket, Battery charger, Bilge pump – Electric, Inverter, Shore power cable, Solar panels, Watermaker – desalinator

# PRICE AND AVAILABILITY

Bali 4.3 Patrizia (2020)



|   |   |   |   |
|---|---|---|---|
| <b>30.05. – 06.06.2026</b><br>Not available   | <b>06.06. – 13.06.2026</b><br>Not available   | <b>13.06. – 20.06.2026</b><br>Not available   | <b>20.06. – 27.06.2026</b><br>Not available   |
| <b>27.06. – 04.07.2026</b><br>Not available   | <b>04.07. – 11.07.2026</b><br>Not available   | <b>11.07. – 18.07.2026</b><br>Not available   | <b>18.07. – 25.07.2026</b><br>Not available   |
| <b>25.07. – 01.08.2026</b><br>Not available   | <b>01.08. – 15.08.2026</b><br>Not available   | <b>15.08. – 22.08.2026</b><br>Not available   | <b>22.08. – 29.08.2026</b><br>Not available   |
| <b>29.08. – 05.09.2026</b><br>Not available   | <b>05.09. – 12.09.2026</b><br>Not available   | <b>12.09. – 19.09.2026</b><br>Not available   | <b>19.09. – 26.09.2026</b><br>Not available   |
| <b>26.09. – 03.10.2026</b><br>Not available   | <b>03.10. – 10.10.2026</b><br>3.158 € 4.210 € | <b>10.10. – 17.10.2026</b><br>3.158 € 4.210 € | <b>17.10. – 24.10.2026</b><br>3.158 € 4.210 € |
| <b>24.10. – 31.10.2026</b><br>3.158 € 4.210 € | <b>31.10. – 07.11.2026</b><br>3.158 € 4.210 € | <b>07.11. – 14.11.2026</b><br>3.158 € 4.210 € | <b>14.11. – 21.11.2026</b><br>4.210 €         |
| <b>21.11. – 28.11.2026</b><br>4.210 €         | <b>28.11. – 05.12.2026</b><br>4.210 €         | <b>05.12. – 12.12.2026</b><br>4.210 €         | <b>12.12. – 19.12.2026</b><br>4.210 €         |
| <b>19.12. – 26.12.2026</b><br>4.210 €         |   |   |   |