

EXCESS 11

DAY DREAMER V (2024)



Conviva Maris D.O.O. • Paraćeva 8 • 21000 Split • Croatia

Phone: +385 91 300 2377

E-mail: info@croatia-holidays-charter.com

Web: www.croatia-holidays-charter.com

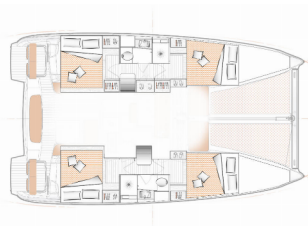

Yacht Base Tivat, Marina Solila,
Montenegro

Yacht ID 7709

Yacht Brands Excess

Yacht Name DAY DREAMER V

Production Year 2024

Length 11.42 M

Cabins 4 + 2

Berths 8 + 2

Max Persons 10

WC 2

COMFORT: Cockpit cushions

DECK: Anchor, Bathing platform, Bimini top, Cockpit/stern, outside shower, Deck brush, Dinghy, Electric anchor windlass, Fenders, Outboard engine, Plastic bucket, Sprayhood

ENTERTAINMENT: Fusion radio, Outdoor speakers, USB

GALLEY: Hot water, Kitchen utensils (Galley equipment, cutlery), Oven, Refrigerator, Stove

INTERIOR: Electric fans in cabins, Electric toilet, Inside shower

NAVIGATION: Autopilot, Compass, GPS, GPS chart plotter, Logge/Lot/Speed, Nautical charts, Navigation set, Wind instrument/Anemometer

SAFETY: Black Water Tank, Fire extinguisher, First aid kit, Flashlight, Safety equipment, Set of tools, VHF radio

SAILS: Lazy bag, Lazy jacks

YACHT ELECTRICS: Solar panels, Watermaker - desalinator

PRICE AND AVAILABILITY

Excess 11 DAY DREAMER V (2024)



| | | | |
|---|---|---|---|
| 30.05. – 06.06.2026 2.755 € 3.935 € | 06.06. – 13.06.2026 Not available | 13.06. – 20.06.2026 On option | 20.06. – 27.06.2026 4.110 € 5.872 € |
| 27.06. – 04.07.2026 Not available | 04.07. – 11.07.2026 4.110 € 5.872 € | 11.07. – 18.07.2026 Not available | 18.07. – 25.07.2026 4.110 € 5.872 € |
| 25.07. – 01.08.2026 4.385 € 6.264 € | 01.08. – 08.08.2026 4.385 € 6.264 € | 08.08. – 15.08.2026 Not available | 15.08. – 22.08.2026 4.385 € 6.264 € |
| 22.08. – 29.08.2026 Not available | 29.08. – 05.09.2026 3.618 € 5.168 € | 05.09. – 12.09.2026 4.651 € 5.168 € | 12.09. – 19.09.2026 4.651 € 5.168 € |
| 19.09. – 26.09.2026 4.651 € 5.168 € | 26.09. – 03.10.2026 Not available | 03.10. – 10.10.2026 3.173 € 3.525 € | 10.10. – 17.10.2026 3.173 € 3.525 € |
| 17.10. – 24.10.2026 3.173 € 3.525 € | 24.10. – 31.10.2026 3.173 € 3.525 € | 31.10. – 07.11.2026 2.996 € 3.525 € | 07.11. – 14.11.2026 2.996 € 3.525 € |
| 14.11. – 21.11.2026 2.996 € 3.525 € | 21.11. – 28.11.2026 2.996 € 3.525 € | 30.11. – 30.12.2026 Not available | |