

# EXCESS 11

Bronze Kiss (2023)



## Conviva Maris D.O.O. • Paraćeva 8 • 21000 Split • Croatia

Phone: +385 91 300 2377

E-mail: [info@croatia-holidays-charter.com](mailto:info@croatia-holidays-charter.com)

Web: [www.croatia-holidays-charter.com](http://www.croatia-holidays-charter.com)

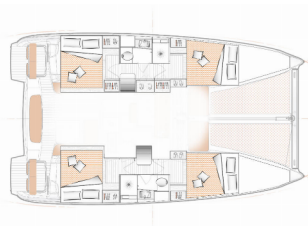

|                        |                           |
|------------------------|---------------------------|
| <b>Yacht Base</b>      | ACI Marina Split, Croatia |
| <b>Yacht ID</b>        | 7669                      |
| <b>Yacht Brands</b>    | Excess                    |
| <b>Yacht Name</b>      | Bronze Kiss               |
| <b>Production Year</b> | 2023                      |
| <b>Length</b>          | 11.42 M                   |
| <b>Cabins</b>          | 4 + 2                     |
| <b>Berths</b>          | 8 + 2 + 2                 |
| <b>WC</b>              | 2                         |

**COMFORT:** Cockpit cushions

**DECK:** Anchor with chain, Bilge pump - Mechanic, Cockpit table, Cockpit/stern, outside shower, Dinghy with outboard engine, Spare anchor (Reserve, Auxiliary anchor), Stern platform

**GALLEY:** Hot water, Kitchen utensils (Galley equipment, cutlery), Refrigerator

**INTERIOR:** Convertible table in salon

**NAVIGATION:** Autopilot, Binoculars, Compass, GPS chart plotter, Radar reflector, Wind instrument/Anemometer, Windex

**SAFETY:** Distress flare box, Emergency tiller, Fire extinguisher, First aid kit, Flashlight, Fog horn, Inflatable life raft, Set of tools, VHF radio

**YACHT ELECTRICS:** 12V Socket, 220V socket, Air Conditioning, Battery charger, Generator, Shore connection 220 V

# PRICE AND AVAILABILITY

Excess 11 Bronze Kiss (2023)



|   |   |   |   |
|---|---|---|---|
| <b>03.06. – 07.06.2026</b><br>Not available   | <b>13.06. – 20.06.2026</b><br>Not available   | <b>25.06. – 28.06.2026</b><br>Not available   | <b>30.06. – 04.07.2026</b><br>Not available   |
| <b>04.07. – 11.07.2026</b><br>Not available   | <b>13.07. – 16.07.2026</b><br>Not available   | <b>16.07. – 30.07.2026</b><br>Not available   | <b>01.08. – 08.08.2026</b><br>On option       |
| <b>08.08. – 15.08.2026</b><br>Not available   | <b>15.08. – 22.08.2026</b><br>Not available   | <b>22.08. – 29.08.2026</b><br>Not available   | <b>29.08. – 05.09.2026</b><br>4.042 € 4.300 € |
| <b>05.09. – 12.09.2026</b><br>Not available   | <b>12.09. – 19.09.2026</b><br>Not available   | <b>19.09. – 26.09.2026</b><br>Not available   | <b>26.09. – 03.10.2026</b><br>3.158 € 3.360 € |
| <b>03.10. – 10.10.2026</b><br>3.158 € 3.360 € | <b>10.10. – 17.10.2026</b><br>3.158 € 3.360 € | <b>17.10. – 24.10.2026</b><br>3.158 € 3.360 € | <b>24.10. – 31.10.2026</b><br>3.158 € 3.360 € |
| <b>31.10. – 07.11.2026</b><br>3.158 € 3.360 € | <b>07.11. – 14.11.2026</b><br>3.158 € 3.360 € | <b>14.11. – 21.11.2026</b><br>3.158 € 3.360 € | <b>21.11. – 28.11.2026</b><br>3.158 € 3.360 € |
| <b>28.11. – 05.12.2026</b><br>3.158 € 3.360 € | <b>05.12. – 12.12.2026</b><br>3.158 € 3.360 € | <b>12.12. – 19.12.2026</b><br>3.158 € 3.360 € | <b>19.12. – 26.12.2026</b><br>3.158 € 3.360 € |