

EXCESS 11

Spring & Fall (2024)



Conviva Maris D.O.O. • Paraćeva 8 • 21000 Split • Croatia

Phone: +385 91 300 2377

E-mail: info@croatia-holidays-charter.com

Web: www.croatia-holidays-charter.com

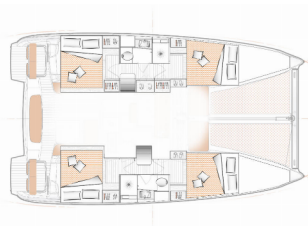

Yacht Base	Trogir, Marina Trogir (ex.SCT), Croatia
Yacht ID	7313
Yacht Brands	Excess
Yacht Name	Spring & Fall
Production Year	2024
Length	11.42 M
Cabins	4 + 2
Berths	8 + 2 + 2
WC	2

COMFORT: Bedlinen and towels, Cockpit cushions, Sundeck cushions

DECK: Anchor with chain, Bilge pump - Mechanic, Bimini top, Boat hook, Cockpit light, Cockpit table, Cockpit/stern, outside shower, Davit, Dinghy with outboard engine, Electric anchor windlass, Fenders, Jerry cans for diesel, Swimming ladder

ENTERTAINMENT: Fusion radio, Indoor speakers, Outdoor speakers, Wi-Fi Internet

GALLEY: Freezer, Gas bottles, Hot water, Kitchen utensils (Galley equipment, cutlery), NESPRESSO coffee machine, Refrigerator

INTERIOR: Curtains over portlights and curtains to separate salon, Electric fans, Electric toilet

NAVIGATION: 3 blade folding propeller, Autopilot, Complete navigation equipment, GPS chart plotter, Navigation (Nautical) charts and nautical guide

SAFETY: Black Water Tank, Distress signals, First aid kit, Life belts (Safety harness), Life jackets, VHF radio

SAILS: Electric winch

YACHT ELECTRICS: Air Conditioning, Battery charger, Bilge pump - Electric, Generator, Heating, Inverter, Shore connection 220 V, Solar panels

PRICE AND AVAILABILITY

Excess 11 Spring & Fall (2024)



30.05. – 06.06.2026 Not available	06.06. – 13.06.2026 Not available	13.06. – 20.06.2026 Not available	20.06. – 27.06.2026 Not available
27.06. – 04.07.2026 Not available	04.07. – 11.07.2026 4.350 € 4.579 €	11.07. – 18.07.2026 Not available	18.07. – 25.07.2026 Not available
25.07. – 01.08.2026 5.833 € 6.140 €	01.08. – 08.08.2026 Not available	08.08. – 15.08.2026 Not available	15.08. – 22.08.2026 Not available
22.08. – 12.09.2026 Not available	12.09. – 19.09.2026 Not available	19.09. – 26.09.2026 Not available	26.09. – 03.10.2026 2.550 € 2.684 €
03.10. – 10.10.2026 2.015 € 2.121 €	10.10. – 17.10.2026 1.850 € 1.947 €	17.10. – 24.10.2026 1.600 € 1.684 €	24.10. – 31.10.2026 1.600 € 1.684 €
01.11. – 26.03.2027 Not available			