

# BALI CATSPACE

Pinnacle Cat (2022)



Conviva Maris D.O.O. • Paraćeva 8 • 21000 Split • Croatia

Phone: +385 91 300 2377

E-mail: [info@croatia-holidays-charter.com](mailto:info@croatia-holidays-charter.com)

Web: [www.croatia-holidays-charter.com](http://www.croatia-holidays-charter.com)

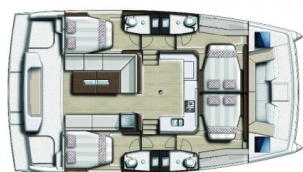

<b>Yacht Base</b>	BVI, Hodge's Creek Marina, British Virgin Islands
<b>Yacht ID</b>	7267
<b>Yacht Brands</b>	Catana
<b>Yacht Name</b>	Pinnacle Cat
<b>Production Year</b>	2022
<b>Length</b>	12.31 M
<b>Cabins</b>	4
<b>Berths</b>	8 + 2
<b>Max Persons</b>	10
<b>WC</b>	4

**COMFORT:** Cockpit cushions, Deck cushions, Forward cockpit cushions, Helmsman seat cushions

**DECK:** Bimini top, Cockpit/stern, outside shower, Davit, Electric anchor windlass, Grill/Barbecue/Plancha, Seats for aft bench, Swimming ladder

**GALLEY:** Oven, Refrigerator, Stove

**INTERIOR:** Electric fans in cabins, Salon table

**NAVIGATION:** Autopilot, GPS chart plotter

**SAFETY:** Extra water tank, VHF radio

**SAILS:** Lazy bag

**YACHT ELECTRICS:** Air Conditioning, Battery charger, Generator, Inverter, Service batteries, Watermaker - desalinator

# PRICE AND AVAILABILITY

Bali Catspace Pinnacle Cat (2022)



<b>30.05. – 06.06.2026</b> 5.175 €	<b>06.06. – 13.06.2026</b> 5.175 €	<b>13.06. – 20.06.2026</b> 5.175 €	<b>20.06. – 27.06.2026</b> 5.175 €
<b>28.06. – 07.07.2026</b> Not available	<b>11.07. – 18.07.2026</b> 4.312 €	<b>18.07. – 25.07.2026</b> 4.312 €	<b>25.07. – 01.08.2026</b> 4.312 €
<b>01.08. – 08.08.2026</b> 4.312 €	<b>08.08. – 15.08.2026</b> 4.312 €	<b>15.08. – 22.08.2026</b> 4.312 €	<b>22.08. – 29.08.2026</b> 4.312 €
<b>01.09. – 30.09.2026</b> Not available	<b>03.10. – 10.10.2026</b> 4.312 €	<b>10.10. – 17.10.2026</b> 4.312 €	<b>17.10. – 24.10.2026</b> 4.312 €
<b>24.10. – 31.10.2026</b> 4.312 €	<b>31.10. – 07.11.2026</b> 5.051 €	<b>07.11. – 14.11.2026</b> 5.175 €	<b>14.11. – 21.11.2026</b> 5.175 €
<b>21.11. – 28.11.2026</b> 4.916 € <del>5.175 €</del>	<b>28.11. – 05.12.2026</b> 4.331 € <del>4.559 €</del>	<b>05.12. – 12.12.2026</b> 4.097 € <del>4.312 €</del>	<b>12.12. – 19.12.2026</b> 5.501 € <del>5.791 €</del>
<b>19.12. – 26.12.2026</b> 7.762 €	<b>28.12. – 05.01.2027</b> Not available		