

# BAVARIA CRUISER 41

Nixie (2020)



Conviva Maris D.O.O. • Paraćeva 8 • 21000 Split • Croatia

Phone: +385 91 300 2377

E-mail: [info@croatia-holidays-charter.com](mailto:info@croatia-holidays-charter.com)

Web: [www.croatia-holidays-charter.com](http://www.croatia-holidays-charter.com)

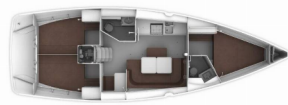

<b>Yacht Base</b>	Marina Zadar (ex. Tankerkomerc), Croatia
<b>Yacht ID</b>	6389
<b>Yacht Brands</b>	Bavaria
<b>Yacht Name</b>	Nixie
<b>Production Year</b>	2020
<b>Length</b>	12.35 M
<b>Cabins</b>	3
<b>Berths</b>	6 + 1
<b>Max Persons</b>	8
<b>WC</b>	2

**DECK:** Anchor with chain, Anchor with rope, Bathing platform, Bilge pump - Mechanic, Bimini top, Boat hook, Bosun's chair (Safe seat) (boatswain's chair), Cockpit light, Cockpit/stern, outside shower, Dinghy, Electric anchor windlass, Fenders, Jerry cans for diesel, Mooring ropes, Sprayhood, Teak cockpit, Water hose

**ENTERTAINMENT:** Radio CD player, TV + DVD

**GALLEY:** Gas bottles, Hot water, Kitchen utensils (Galley equipment, cutlery), Oven, Refrigerator, Stove

**INTERIOR:** Barometer, Inside shower

**NAVIGATION:** Autopilot, Binoculars, Bow thruster, Compass, Complete navigation equipment, GPS chart plotter - cockpit, Hand bearing compass, Log, Speed, Depth- echo sounder, Navigation (Nautical) charts and nautical guide, Radar reflector, Wind instrument/Anemometer

**SAFETY:** Automatic light, Distress flare box, Fire extinguisher, First aid kit, Fog horn, Horseshoe lifebuoy, Life belts (Safety harness), Life jackets, Padlock, Set of tools, Signal rockets and torches, VHF radio

**YACHT ELECTRICS:** Air Conditioning, Battery charger, Bilge pump - Electric, Shore connection 220 V, Shore power cable, Solar panels

# PRICE AND AVAILABILITY

Bavaria Cruiser 41 Nixie (2020)



<b>30.05. – 06.06.2026</b> Not available	<b>06.06. – 20.06.2026</b> Not available	<b>20.06. – 27.06.2026</b> Not available	<b>27.06. – 11.07.2026</b> Not available
<b>11.07. – 18.07.2026</b> Not available	<b>18.07. – 25.07.2026</b> 2.489 € 3.318 €	<b>25.07. – 01.08.2026</b> 2.711 € 3.615 €	<b>01.08. – 08.08.2026</b> 2.711 € 3.615 €
<b>08.08. – 15.08.2026</b> 2.711 € 3.615 €	<b>15.08. – 22.08.2026</b> 2.711 € 3.615 €	<b>22.08. – 29.08.2026</b> 2.356 € 3.141 €	<b>29.08. – 05.09.2026</b> Not available
<b>05.09. – 12.09.2026</b> 2.356 € 3.141 €	<b>12.09. – 19.09.2026</b> 2.356 € 3.141 €	<b>19.09. – 26.09.2026</b> 2.356 € 3.141 €	<b>26.09. – 03.10.2026</b> 1.606 € 2.141 €
<b>03.10. – 10.10.2026</b> 1.606 € 2.141 €	<b>10.10. – 17.10.2026</b> 1.606 € 2.141 €	<b>17.10. – 24.10.2026</b> Not available	<b>24.10. – 31.10.2026</b> 1.606 € 2.141 €
<b>31.10. – 31.12.2026</b> Not available			