

# BALI 4.2 OW

Leo (2025)



Conviva Maris D.O.O. • Paraćeva 8 • 21000 Split • Croatia

Phone: +385 91 300 2377

E-mail: [info@croatia-holidays-charter.com](mailto:info@croatia-holidays-charter.com)

Web: [www.croatia-holidays-charter.com](http://www.croatia-holidays-charter.com)

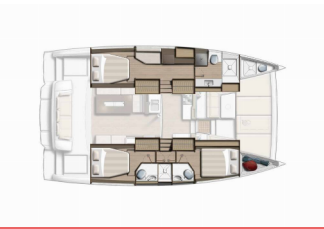

<b>Yacht Base</b>	Lavrion, Main Port, Greece
<b>Yacht ID</b>	6168
<b>Yacht Brands</b>	Catana
<b>Yacht Name</b>	Leo
<b>Production Year</b>	2025
<b>Length</b>	12.85 M
<b>Cabins</b>	3 + 1
<b>Berths</b>	6 + 1
<b>Max Persons</b>	7
<b>WC</b>	3 + 1

**COMFORT:** Cockpit cushions, Helmstation seat cushions, Sun loungers, Sunshades

**DECK:** Bimini top, Cockpit/stern, outside shower, Davit, Electric anchor windlass, Fenders, Flybridge, Grill/Barbecue/Plancha, Mooring ropes, Plastic bucket, Removable cockpit table, Swimming ladder

**ENTERTAINMENT:** Fusion radio

**GALLEY:** Dishwasher, Freezer, Refrigerator, Stove

**INTERIOR:** Ambiantal lighting, Dryer, Electric fans in cabins, Electric toilet, Washing machine

**NAVIGATION:** 3 blade folding propeller, AIS, Autopilot, Compass, GPS chart plotter

**SAFETY:** Automatic Inflatable Life Jacket, EPIRB-Distress radio beacons, First aid kit, Flashlight, Horseshoe lifebuoy, Liferaft, VHF radio

**SAILS:** Code Zero, Electric winch, Lazy bag, Lazy jacks

**YACHT ELECTRICS:** Air Conditioning, Battery charger, Generator, Inverter, Service batteries, Watermaker - desalinator

# PRICE AND AVAILABILITY

Bali 4.2 OW Leo (2025)



<b>30.05. – 06.06.2026</b> Not available	<b>06.06. – 13.06.2026</b> 7.200 € <del>8.000 €</del>	<b>13.06. – 27.06.2026</b> Not available	<b>27.06. – 11.07.2026</b> Not available
<b>11.07. – 18.07.2026</b> Not available	<b>18.07. – 25.07.2026</b> Not available	<b>25.07. – 01.08.2026</b> 10.710 € <del>11.900 €</del>	<b>01.08. – 08.08.2026</b> Not available
<b>08.08. – 15.08.2026</b> 10.710 € <del>11.900 €</del>	<b>15.08. – 22.08.2026</b> Not available	<b>22.08. – 29.08.2026</b> On option	<b>29.08. – 05.09.2026</b> 9.855 € <del>10.950 €</del>
<b>05.09. – 12.09.2026</b> On option	<b>12.09. – 19.09.2026</b> Not available	<b>19.09. – 26.09.2026</b> 8.010 € <del>8.900 €</del>	<b>26.09. – 03.10.2026</b> Not available
<b>03.10. – 31.10.2026</b> Not available	<b>31.10. – 07.11.2026</b> 4.680 € <del>5.200 €</del>	<b>07.11. – 14.11.2026</b> 4.680 € <del>5.200 €</del>	<b>14.11. – 21.11.2026</b> 4.680 € <del>5.200 €</del>
<b>21.11. – 28.11.2026</b> 4.680 € <del>5.200 €</del>	<b>28.11. – 05.12.2026</b> 5.200 €	<b>05.12. – 12.12.2026</b> 5.200 €	<b>12.12. – 19.12.2026</b> 5.200 €
<b>19.12. – 26.12.2026</b> 5.200 €			