

EXCESS 11

One Dance (2025)



Conviva Maris D.O.O. • Paraćeva 8 • 21000 Split • Croatia

Phone: +385 91 300 2377

E-mail: info@croatia-holidays-charter.com

Web: www.croatia-holidays-charter.com

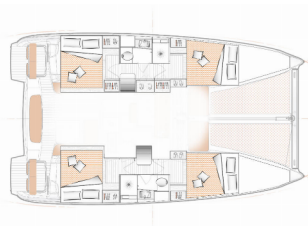

Yacht Base Preveza, Main Port, Greece

Yacht ID 5806

Yacht Brands Excess

Yacht Name One Dance

Production Year 2025

Length 11.42 M

Cabins 4 + 2

Berths 8 + 2 + 2

WC 2 + 1

COMFORT: Bed linen, Blankets, Cockpit cushions, Pillows, Towels

DECK: Bilge pump – Mechanic, Black ball, Boat hook, Bosun's chair (Safe seat) (boatswain's chair), Cockpit/stern, outside shower, Dinghy, Dinghy with outboard engine, Electric anchor windlass, Fenders, Fuel funnel, Gangway, Jerry cans for fuel, Main anchor, Mooring ropes, Outboard engine, Plastic bucket, Spare anchor (Reserve, Auxiliary anchor), Swimming ladder, Water hose

ENTERTAINMENT: Outdoor speakers, Radio, Snorkeling equipment

GALLEY: Gas cookers, Hot water, Kitchen utensils (Galley equipment, cutlery), Refrigerator, Stove

INTERIOR: Barometer, Clock, Electric fans, Electric toilet, Yacht documents

NAVIGATION: Autopilot, Binoculars, Compass, Divider, nautic chart, Echosounder/Depthsounder, GPS chart plotter – cockpit, Hand bearing compass, Nautical charts, Parallel ruler, Pilot book, Radar reflector, Speedometer (Speed log), Wind instrument/Anemometer

SAFETY: Distress flare box, Emergency tiller, Engine spare parts, Fire extinguisher, First aid kit, Floating light, Fog horn, Horseshoe lifebuoy, Life belts (Safety harness), Life jackets, Liferaft, Oars (Paddles), Repair kit, Set of tools, Torch, VHF radio, Wire (shroud) cutter

SAILS: Electric winch, Lazy bag, Lazy jacks

YACHT ELECTRICS: Battery charger, Bilge pump – Electric, Shore connection 220 V, Solar panels

PRICE AND AVAILABILITY

Excess 11 One Dance (2025)



30.05. – 06.06.2026 3.445 € 5.300€	06.06. – 13.06.2026 3.445 € 5.300€	13.06. – 20.06.2026 3.803 € 5.850€	20.06. – 27.06.2026 Not available
27.06. – 04.07.2026 4.485 € 6.900€	04.07. – 11.07.2026 5.175 € 6.900€	11.07. – 18.07.2026 5.175 € 6.900€	18.07. – 25.07.2026 On option
25.07. – 01.08.2026 On option	01.08. – 08.08.2026 On option	08.08. – 15.08.2026 5.850 € 7.800€	15.08. – 22.08.2026 5.850 € 7.800€
22.08. – 29.08.2026 4.988 € 6.650€	29.08. – 05.09.2026 Not available	05.09. – 12.09.2026 4.988 € 6.650€	12.09. – 19.09.2026 4.800 € 6.400€
19.09. – 26.09.2026 Not available	26.09. – 03.10.2026 Not available	03.10. – 10.10.2026 3.488 € 4.650€	10.10. – 17.10.2026 3.075 € 4.100€
17.10. – 24.10.2026 3.150 € 3.500€	24.10. – 31.10.2026 Not available	31.10. – 07.11.2026 3.150 € 3.500€	07.11. – 14.11.2026 3.150 € 3.500€
14.11. – 21.11.2026 3.150 € 3.500€	21.11. – 31.12.2026 Not available		