

# EXCESS 11

Alia (2024)



## Conviva Maris D.O.O. • Paraćeva 8 • 21000 Split • Croatia

Phone: +385 91 300 2377

E-mail: [info@croatia-holidays-charter.com](mailto:info@croatia-holidays-charter.com)

Web: [www.croatia-holidays-charter.com](http://www.croatia-holidays-charter.com)

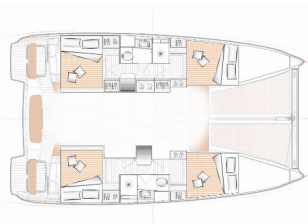
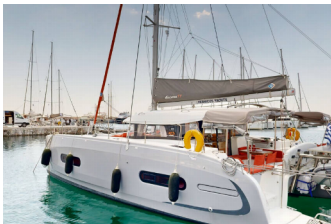

<b>Yacht Base</b>	Rhodes New Marina, Greece
<b>Yacht ID</b>	5009
<b>Yacht Brands</b>	Excess
<b>Yacht Name</b>	Alia
<b>Production Year</b>	2024
<b>Length</b>	11.42 M
<b>Cabins</b>	4 + 1
<b>Berths</b>	8 + 1 + 1
<b>WC</b>	2

**COMFORT:** Cockpit cushions

**DECK:** Bimini top, Dinghy, Gangway, Outboard engine

**ENTERTAINMENT:** Radio, Snorkeling equipment, Stand up paddle (SUP) - FREE

**GALLEY:** Coffee machine, NESPRESSO coffee machine

**INTERIOR:** Convertible table in salon, Electric fans, Electric toilet

**NAVIGATION:** Autopilot, GPS chart plotter - cockpit

**SAILS:** Electric winch

**YACHT ELECTRICS:** Air Conditioning, Inverter, Solar panels, USB sockets

# PRICE AND AVAILABILITY

Excess 11 Alia (2024)



<b>23.05. – 30.05.2026</b> 3.575 € 5.500€	<b>30.05. – 06.06.2026</b> Not available	<b>06.06. – 13.06.2026</b> 4.176 € 5.800€	<b>13.06. – 20.06.2026</b> On option
<b>20.06. – 04.07.2026</b> Not available	<b>04.07. – 11.07.2026</b> 4.896 € 6.800€	<b>11.07. – 18.07.2026</b> 5.780 € 6.800€	<b>18.07. – 25.07.2026</b> Not available
<b>25.07. – 01.08.2026</b> 5.780 € 6.800€	<b>01.08. – 08.08.2026</b> 6.636 € 7.900€	<b>08.08. – 15.08.2026</b> 6.715 € 7.900€	<b>15.08. – 22.08.2026</b> Not available
<b>22.08. – 29.08.2026</b> 5.610 € 6.600€	<b>29.08. – 05.09.2026</b> 4.884 € 6.600€	<b>05.09. – 12.09.2026</b> 4.884 € 6.600€	<b>12.09. – 19.09.2026</b> 5.400 € 6.000€
<b>19.09. – 26.09.2026</b> Not available	<b>26.09. – 03.10.2026</b> Not available	<b>03.10. – 10.10.2026</b> Not available	<b>10.10. – 17.10.2026</b> Not available
<b>17.10. – 24.10.2026</b> 2.700 € 3.600€	<b>24.10. – 31.10.2026</b> 2.700 € 3.600€	<b>31.10. – 07.11.2026</b> 2.520 € 3.600€	<b>07.11. – 14.11.2026</b> 2.520 € 3.600€
<b>14.11. – 21.11.2026</b> 3.240 € 3.600€	<b>21.11. – 28.11.2026</b> 3.240 € 3.600€	<b>28.11. – 05.12.2026</b> 3.240 € 3.600€	<b>05.12. – 12.12.2026</b> 3.240 € 3.600€
<b>12.12. – 19.12.2026</b> 3.240 € 3.600€	<b>19.12. – 26.12.2026</b> 3.240 € 3.600€		