

# EXCESS 11

Amare II (2023)



## Conviva Maris D.O.O. • Paraćeva 8 • 21000 Split • Croatia

Phone: +385 91 300 2377

E-mail: [info@croatia-holidays-charter.com](mailto:info@croatia-holidays-charter.com)

Web: [www.croatia-holidays-charter.com](http://www.croatia-holidays-charter.com)

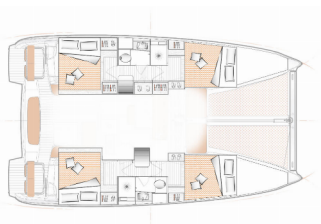

**DECK:** Bimini top, Cockpit table, Cockpit/stern, outside shower, Dinghy, Electric anchor windlass, Gangway, Outboard engine

**ENTERTAINMENT:** Snorkeling equipment

**GALLEY:** Hot water, Kitchen utensils (Galley equipment, cutlery), Refrigerator

**INTERIOR:** Electric toilet

**NAVIGATION:** Autopilot, GPS chart plotter - cockpit

**SAFETY:** Liferaft, VHF radio

**SAILS:** Lazy jacks

**YACHT ELECTRICS:** Battery charger, Inverter, Solar panels

**Yacht Base** Corfu, Gouvia Marina, Greece

**Yacht ID** 4880

**Yacht Brands** Excess

**Yacht Name** Amare II

**Production Year** 2023

**Length** 11.42 M

**Cabins** 4 + 1

**Berths** 8 + 1 + 1

**WC** 2

# PRICE AND AVAILABILITY

Excess 11 Amare II (2023)



<b>30.05. – 06.06.2026</b> Not available	<b>06.06. – 13.06.2026</b> 4.500 € <del>5.000 €</del>	<b>13.06. – 20.06.2026</b> Not available	<b>20.06. – 27.06.2026</b> Not available
<b>27.06. – 04.07.2026</b> 5.400 € <del>6.000 €</del>	<b>04.07. – 11.07.2026</b> Not available	<b>11.07. – 18.07.2026</b> Not available	<b>18.07. – 25.07.2026</b> Not available
<b>25.07. – 08.08.2026</b> Not available	<b>08.08. – 15.08.2026</b> 6.480 € <del>7.200 €</del>	<b>15.08. – 22.08.2026</b> On option	<b>22.08. – 29.08.2026</b> 5.850 € <del>6.500 €</del>
<b>29.08. – 05.09.2026</b> 5.850 € <del>6.500 €</del>	<b>05.09. – 12.09.2026</b> Not available	<b>12.09. – 19.09.2026</b> Not available	<b>19.09. – 03.10.2026</b> Not available
<b>03.10. – 10.10.2026</b> Not available	<b>10.10. – 17.10.2026</b> 3.315 € <del>4.200 €</del>	<b>17.10. – 24.10.2026</b> Not available	<b>24.10. – 31.10.2026</b> 2.211 € <del>2.500 €</del>
<b>31.10. – 07.11.2026</b> 2.250 € <del>2.500 €</del>	<b>07.11. – 14.11.2026</b> 2.250 € <del>2.500 €</del>	<b>14.11. – 21.11.2026</b> 2.250 € <del>2.500 €</del>	<b>21.11. – 28.11.2026</b> 2.250 € <del>2.500 €</del>
<b>28.11. – 05.12.2026</b> 2.250 € <del>2.500 €</del>	<b>05.12. – 12.12.2026</b> 2.250 € <del>2.500 €</del>	<b>12.12. – 19.12.2026</b> 2.250 € <del>2.500 €</del>	<b>19.12. – 26.12.2026</b> 2.250 € <del>2.500 €</del>