

# LAGOON 380

Karamela (2003)



Conviva Maris D.O.O. • Paraćeva 8 • 21000 Split • Croatia

Phone: +385 91 300 2377

E-mail: [info@croatia-holidays-charter.com](mailto:info@croatia-holidays-charter.com)

Web: [www.croatia-holidays-charter.com](http://www.croatia-holidays-charter.com)

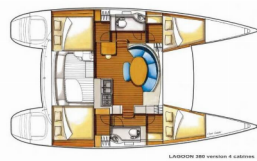

<b>Yacht Base</b>	Nikiti, Greece
<b>Yacht ID</b>	4573
<b>Yacht Brands</b>	Lagoon
<b>Yacht Name</b>	Karamela
<b>Production Year</b>	2003
<b>Length</b>	11.55 M
<b>Cabins</b>	4
<b>Berths</b>	10
<b>WC</b>	2

**COMFORT:** Cockpit cushions

**DECK:** Anchor, Bimini top, Cockpit/stern, outside shower, Dinghy, Outboard engine

**ENTERTAINMENT:** Outdoor speakers, Radio CD player, Snorkeling equipment, Underwater lights

**GALLEY:** Freezer, Hot water, Oven, Refrigerator, Stove

**INTERIOR:** Coolbox, Electric toilet

**NAVIGATION:** Autopilot, Compass, Depthsounder, GPS chart plotter, Navigation (Nautical) charts and nautical guide, Navigation set, Radar, Speedometer (Speed log), Wind instrument/Anemometer

**SAFETY:** Black Water Tank, Distress flare box, Fire extinguisher, First aid kit, Life belts (Safety harness), Life jackets, Liferaft, Safety equipment, VHF radio

**SAILS:** Lazy bag

**YACHT ELECTRICS:** Inverter, Shore power connection, Solar panels

# PRICE AND AVAILABILITY

Lagoon 380 Karamela (2003)



<b>30.05. – 06.06.2026</b> Not available	<b>06.06. – 13.06.2026</b> Not available	<b>13.06. – 18.06.2026</b> Not available	<b>20.06. – 27.06.2026</b> Not available
<b>27.06. – 04.07.2026</b> Not available	<b>04.07. – 11.07.2026</b> Not available	<b>11.07. – 25.07.2026</b> Not available	<b>25.07. – 08.08.2026</b> Not available
<b>08.08. – 15.08.2026</b> Not available	<b>15.08. – 22.08.2026</b> Not available	<b>22.08. – 29.08.2026</b> Not available	<b>29.08. – 05.09.2026</b> Not available
<b>05.09. – 12.09.2026</b> Not available	<b>12.09. – 19.09.2026</b> Not available	<b>20.09. – 28.09.2026</b> Not available	<b>28.09. – 03.10.2026</b> Not available
<b>03.10. – 10.10.2026</b> Not available	<b>10.10. – 17.10.2026</b> 3.600 €	<b>17.10. – 24.10.2026</b> 3.100 €	<b>24.10. – 31.10.2026</b> 3.100 €
<b>31.10. – 07.11.2026</b> 3.100 €	<b>07.11. – 14.11.2026</b> 3.100 €	<b>14.11. – 21.11.2026</b> 3.100 €	<b>21.11. – 28.11.2026</b> 3.100 €
<b>28.11. – 05.12.2026</b> 3.100 €	<b>05.12. – 12.12.2026</b> 3.100 €	<b>12.12. – 19.12.2026</b> 3.100 €	<b>19.12. – 26.12.2026</b> 3.100 €