

# BAVARIA CRUISER 41

Patrizia (2016)



Conviva Maris D.O.O. • Paraćeva 8 • 21000 Split • Croatia

Phone: +385 91 300 2377

E-mail: [info@croatia-holidays-charter.com](mailto:info@croatia-holidays-charter.com)

Web: [www.croatia-holidays-charter.com](http://www.croatia-holidays-charter.com)

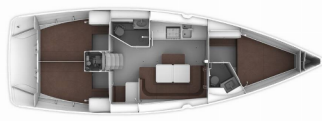

**DECK:** Bimini top, Cockpit table, Cockpit/stern, outside shower, Dinghy, Electric anchor windlass, Sprayhood

**ENTERTAINMENT:** CD MP3 player, TV

**GALLEY:** Refrigerator

**INTERIOR:** Lowerable salon table

**NAVIGATION:** Autopilot, Bow thruster, GPS chart plotter - cockpit, Wind instrument/Anemometer

**SAFETY:** VHF radio

**YACHT ELECTRICS:** Solar panels

**Yacht Base** Sukosan, D-Marin Dalmacija  
Marina, Croatia

**Yacht ID** 425

**Yacht Brands** Bavaria

**Yacht Name** Patrizia

**Production Year** 2016

**Length** 12.35 M

**Cabins** 3

**Berths** 6 + 2

**WC** 2

# PRICE AND AVAILABILITY

Bavaria Cruiser 41 Patrizia (2016)



|                                                          |                                                          |                                                          |                                                          |
|----------------------------------------------------------|----------------------------------------------------------|----------------------------------------------------------|----------------------------------------------------------|
| <b>30.05. – 06.06.2026</b><br>Not available              | <b>06.06. – 13.06.2026</b><br>Not available              | <b>13.06. – 20.06.2026</b><br>Not available              | <b>20.06. – 27.06.2026</b><br>1.911 € <del>2.940 €</del> |
| <b>27.06. – 04.07.2026</b><br>1.983 € <del>3.050 €</del> | <b>04.07. – 11.07.2026</b><br>Not available              | <b>11.07. – 18.07.2026</b><br>Not available              | <b>18.07. – 01.08.2026</b><br>Not available              |
| <b>01.08. – 08.08.2026</b><br>Not available              | <b>08.08. – 15.08.2026</b><br>Not available              | <b>15.08. – 22.08.2026</b><br>Not available              | <b>22.08. – 29.08.2026</b><br>1.859 € <del>2.860 €</del> |
| <b>29.08. – 05.09.2026</b><br>1.762 € <del>2.710 €</del> | <b>05.09. – 12.09.2026</b><br>Not available              | <b>12.09. – 19.09.2026</b><br>Not available              | <b>19.09. – 26.09.2026</b><br>1.790 € <del>2.340 €</del> |
| <b>26.09. – 03.10.2026</b><br>1.568 € <del>2.050 €</del> | <b>03.10. – 10.10.2026</b><br>1.484 € <del>1.940 €</del> | <b>10.10. – 17.10.2026</b><br>1.408 € <del>1.840 €</del> | <b>17.10. – 24.10.2026</b><br>Not available              |
| <b>24.10. – 31.10.2026</b><br>1.170 € <del>1.530 €</del> | <b>31.10. – 07.11.2026</b><br>1.170 € <del>1.530 €</del> | <b>07.11. – 14.11.2026</b><br>1.170 € <del>1.530 €</del> | <b>14.11. – 21.11.2026</b><br>1.170 € <del>1.530 €</del> |
| <b>21.11. – 28.11.2026</b><br>1.170 € <del>1.530 €</del> | <b>28.11. – 05.12.2026</b><br>1.170 € <del>1.530 €</del> | <b>05.12. – 12.12.2026</b><br>1.170 € <del>1.530 €</del> | <b>12.12. – 19.12.2026</b><br>1.170 € <del>1.530 €</del> |
| <b>19.12. – 26.12.2026</b><br>1.170 € <del>1.530 €</del> |                                                          |                                                          |                                                          |