

# BAVARIA CRUISER 41

MH 60 (2016)



Conviva Maris D.O.O. • Paraćeva 8 • 21000 Split • Croatia

Phone: +385 91 300 2377

E-mail: [info@croatia-holidays-charter.com](mailto:info@croatia-holidays-charter.com)

Web: [www.croatia-holidays-charter.com](http://www.croatia-holidays-charter.com)

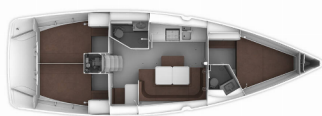

<b>Yacht Base</b>	Marina Hramina, Murter, Croatia
<b>Yacht ID</b>	298
<b>Yacht Brands</b>	Bavaria
<b>Yacht Name</b>	MH 60
<b>Production Year</b>	2016
<b>Length</b>	12.35 M
<b>Cabins</b>	3
<b>Berths</b>	6 + 1
<b>Max Persons</b>	7
<b>WC</b>	2

**COMFORT:** Bed linen, Blankets, Pillows, Towels

**DECK:** Anchor with chain, Bathing platform, Bilge pump - Mechanic, Bimini top, Boat hook, Bosun's chair (Safe seat) (boatswain's chair), Cockpit table, Cockpit/stern, outside shower, Deck brush, Dinghy, Electric anchor windlass, Fenders, Fuel funnel, Gangway, Impeller, Jerry cans for diesel, Main Deck Compass, Mooring ropes, Plastic bucket, Reserve motor oil, Sprayhood, Swimming ladder, Teak cockpit, Water hose, Winch handles

**ENTERTAINMENT:** DVD player, LCD TV, Radio CD player

**GALLEY:** Gas bottles, Gas cookers, Hot water, Kitchen utensils (Galley equipment, cutlery), Oven, Refrigerator, Sink, Water pump

**INTERIOR:** Barometer, Thermometer, Toilet paper

**NAVIGATION:** Autopilot, Binoculars, Bow thruster, GPS chart plotter, Hand bearing compass, Log, Speed, Depth- echo sounder, Navigation (Nautical) charts and nautical guide, Navigation set, Pilot book, Wind instrument/Anemometer

**SAFETY:** Distress signals, Emergency tiller, Fire extinguisher, First aid kit, Fog horn, Life belts (Safety harness), Life buoy + Flashing light, Life jackets, Oars (Paddles), Search light, Set of tools, Spare parts, Torch, VHF radio

**YACHT ELECTRICS:** Batteries, Battery charger, Bilge pump - Electric, Heating, Plug 220V, 12 V, Pump, Shore connection 220 V, Start battery

# PRICE AND AVAILABILITY

Bavaria Cruiser 41 MH 60 (2016)



<b>30.05. – 02.06.2026</b> Not available	<b>03.06. – 06.06.2026</b> On option	<b>06.06. – 13.06.2026</b> 2.310 € <del>3.300 €</del>	<b>13.06. – 20.06.2026</b> 2.310 € <del>3.300 €</del>
<b>20.06. – 27.06.2026</b> 1.980 € <del>3.300 €</del>	<b>27.06. – 04.07.2026</b> 1.980 € <del>3.300 €</del>	<b>04.07. – 11.07.2026</b> 2.100 € <del>3.500 €</del>	<b>11.07. – 18.07.2026</b> 2.100 € <del>3.500 €</del>
<b>18.07. – 25.07.2026</b> On option	<b>25.07. – 01.08.2026</b> On option	<b>01.08. – 08.08.2026</b> 2.100 € <del>3.500 €</del>	<b>08.08. – 15.08.2026</b> 2.100 € <del>3.500 €</del>
<b>15.08. – 22.08.2026</b> 1.980 € <del>3.300 €</del>	<b>22.08. – 29.08.2026</b> 1.980 € <del>3.300 €</del>	<b>29.08. – 05.09.2026</b> 1.980 € <del>3.300 €</del>	<b>05.09. – 10.09.2026</b> Not available
<b>12.09. – 19.09.2026</b> 2.465 € <del>2.900 €</del>	<b>19.09. – 23.09.2026</b> Not available	<b>26.09. – 03.10.2026</b> 2.210 € <del>2.600 €</del>	<b>03.10. – 10.10.2026</b> 2.210 € <del>2.600 €</del>
<b>14.10. – 17.10.2026</b> Not available	<b>17.10. – 20.10.2026</b> Not available	<b>24.10. – 31.10.2026</b> 1.615 € <del>1.900 €</del>	<b>31.10. – 07.11.2026</b> 1.615 € <del>1.900 €</del>
<b>07.11. – 14.11.2026</b> 1.615 € <del>1.900 €</del>	<b>14.11. – 21.11.2026</b> 1.615 € <del>1.900 €</del>	<b>21.11. – 28.11.2026</b> 1.615 € <del>1.900 €</del>	<b>28.11. – 05.12.2026</b> 1.615 € <del>1.900 €</del>
<b>05.12. – 12.12.2026</b> 1.615 € <del>1.900 €</del>	<b>12.12. – 19.12.2026</b> 1.615 € <del>1.900 €</del>	<b>19.12. – 26.12.2026</b> 1.615 € <del>1.900 €</del>	