

LAGOON 40

Monarch (2020)



Conviva Maris D.O.O. • Paraćeva 8 • 21000 Split • Croatia

Phone: +385 91 300 2377

E-mail: info@croatia-holidays-charter.com

Web: www.croatia-holidays-charter.com

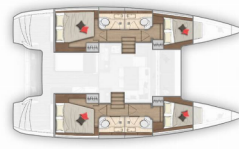

4 cabins 4 Bains de bain / 4 cabins 4 bathrooms

Yacht Base	Marina Kremik, Primosten, Croatia
Yacht ID	1642
Yacht Brands	Lagoon
Yacht Name	Monarch
Production Year	2020
Length	11.74 M
Cabins	4 + 2
Berths	8 + 2 + 2
Max Persons	12
WC	4

COMFORT: Cockpit cushions, Sundeck cushions

DECK: Anchor with chain, Bimini top, Cockpit table, Cockpit/stern, outside shower, Dinghy, Flybridge, Main anchor, Outboard engine, Spare anchor (Reserve, Auxiliary anchor), Swimming ladder, Teak cockpit

ENTERTAINMENT: Indoor speakers, Outdoor speakers

GALLEY: Additional fridge, Hot water, Kitchen utensils (Galley equipment, cutlery), Oven, Refrigerator, Stove

INTERIOR: Electric toilet, LED interior lights

NAVIGATION: Autopilot, Complete navigation equipment, Echosounder/Depthsounder, LED Navigation lights, Pilot book, Radar reflector, Wind instrument/Anemometer

SAFETY: Distress flare box, Fire extinguisher, First aid kit, Horseshoe lifebuoy, Life belts (Safety harness), Life jackets, Liferaft, Smoke detector, VHF radio

SAILS: Lazy bag

YACHT ELECTRICS: 12V Socket, 220V socket, Air Conditioning, Battery charger, Generator, Service batteries, Shore connection 220 V, USB sockets

PRICE AND AVAILABILITY

Lagoon 40 Monarch (2020)



30.05. – 06.06.2026 Not available	06.06. – 13.06.2026 Not available	13.06. – 20.06.2026 4.838 € 6.450 €	20.06. – 27.06.2026 Not available
27.06. – 04.07.2026 5.438 € 7.250 €	04.07. – 11.07.2026 Not available	11.07. – 25.07.2026 Not available	25.07. – 01.08.2026 5.588 € 7.450 €
01.08. – 08.08.2026 Not available	08.08. – 15.08.2026 Not available	15.08. – 22.08.2026 Not available	22.08. – 29.08.2026 5.138 € 6.850 €
29.08. – 05.09.2026 4.838 € 6.450 €	05.09. – 12.09.2026 4.838 € 6.450 €	12.09. – 19.09.2026 3.713 € 4.950 €	19.09. – 26.09.2026 3.263 € 4.350 €
26.09. – 03.10.2026 Not available	03.10. – 10.10.2026 2.063 € 2.750 €	10.10. – 17.10.2026 2.063 € 2.750 €	17.10. – 24.10.2026 2.063 € 2.750 €
24.10. – 31.10.2026 2.063 € 2.750 €	31.10. – 07.11.2026 2.063 € 2.750 €	07.11. – 14.11.2026 2.063 € 2.750 €	14.11. – 21.11.2026 2.063 € 2.750 €
21.11. – 28.11.2026 2.063 € 2.750 €	28.11. – 05.12.2026 2.063 € 2.750 €	05.12. – 12.12.2026 2.063 € 2.750 €	12.12. – 19.12.2026 2.063 € 2.750 €
19.12. – 26.12.2026 2.063 € 2.750 €			